

## GS-52T15 Free Stop Stay

Top opening · Downward opening · Upward opening · Swing door opening

Opening Direction	Torque
	$1.5 \pm 20\% \text{ N} \cdot \text{m/pc}$ $(15.3 \pm 20\% \text{ kgf} \cdot \text{cm/pc})$

### Features

- Disk structure that generates torque by the friction of metal plates
- Thin and space-saving, maximising space inside of the cabinet
- Passed 20,000 life cycle test

### Notes

- Do not operate continuously (repeatedly in a short time)
- Do not contact with water, oil and lubricant, etc.

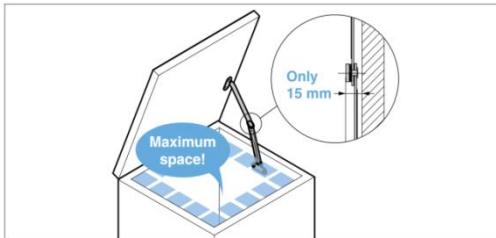

Distance from the mounting surface to the disk surface of stay is only 15mm, maximising space inside of the cabinet.

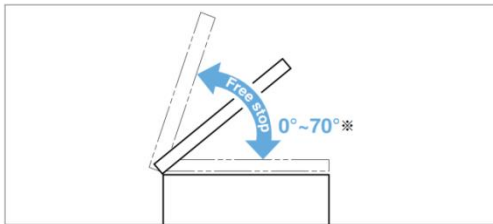

※Opening angle changes depending on installation position.  
(70° is for installation as per Right)

### [Right Side Installation (For Top-opening)]

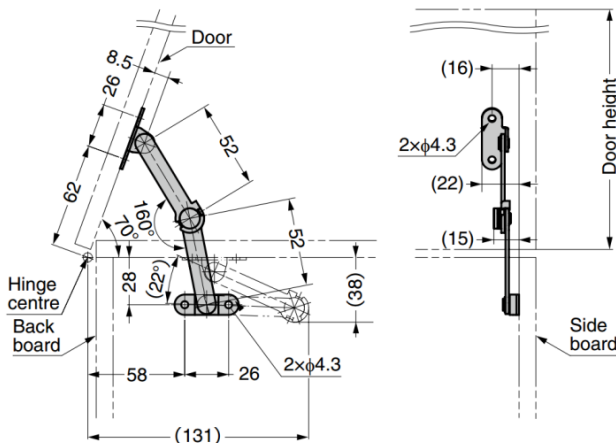

- Relations between door height and door weight for free stop are listed in the table below.
- The following table shows the values for installation below. For reference only.

Door Height	Door Weight kg/pc	Door Weight kg/pair
200	Max. 1.8	Max. 3.6
250	Max. 1.4	Max. 2.8
300	Max. 1.2	Max. 2.4
350	Max. 1.0	Max. 2.0
400	Max. 0.9	Max. 1.8

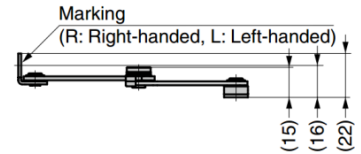
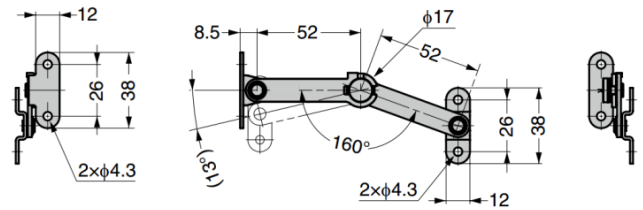

Part No.	Type	Material	Finish	Torque (per piece)	
GS-52T15R	Right-handed	Stainless Steel 430	Barrel Polished	1.5 ±20% N.m	15.3 ±20% kgf.cm
GS-52T15L	Left-handed				